

CODED

Ohio Historic Preservation Office

1985 Velma Avenue
Columbus, Ohio 43211
614/297-2470



OHIO HISTORICAL SOCIETY
SINCE 1885

OHIO HISTORIC INVENTORY

1. No. BUT-1524-8	2. County Butler	4. Present Name(s) Ellison Harkrader House		<input type="checkbox"/> Coded															
3. Location of Negatives		5. Historic or Other Name(s)																	
Roll No.	Picture No.(s)																		
6. Specific Address or Location West side Cincinnati-Dayton Rd., 1.5 miles south of Blueball		16. Thematic Association(s) Agriculture		28. No. of Stories 2															
6a. Lot, Section or VMD Number Lot 15651		17. Date(s) or Period ca. 1850-60	17b. Alteration Date(s) 1930	29. Basement? Yes <input checked="" type="checkbox"/> No <input type="checkbox"/>															
7. City or Village Middletown		18. Style or Design Italianate / Fed/Gir		30. Foundation Material limestone															
8. Site Plan with North Arrow		18a. Style of Addition or Element(s) Greek Revival		31. Wall Construction frame															
		19. Architect or Engineer		32. Roof Type & Material Composition shingle															
		19a. Design Sources		33. No. of Bays Front 3 Side 2															
9. U.T.M. Reference		20. Contractor or Builder		34. Exterior Wall Material(s) Shingle															
Quadrange Name <table border="1" style="font-size: small;"> <tr> <td>1</td><td>7</td><td>7</td><td>2</td><td>8</td><td>2</td><td>0</td><td>0</td> <td>4</td><td>3</td><td>7</td><td>2</td><td>0</td><td>0</td><td>0</td> </tr> </table>		1	7	7	2	8	2	0	0	4	3	7	2	0	0	0	21. Building Type or Plan		35. Plan Shape Square
1	7	7	2	8	2	0	0	4	3	7	2	0	0	0					
Zone Easting Northing 10. Site Building <input checked="" type="checkbox"/> Structure Object <input type="checkbox"/>		22. Original Use, if apparent Residence		36. Changes Addition <input checked="" type="checkbox"/> (Explain in #42) Altered <input type="checkbox"/> Moved <input type="checkbox"/>															
11. On National Register? Yes <input type="checkbox"/> No <input checked="" type="checkbox"/> 12. N.R. Potential? Yes <input type="checkbox"/> No <input checked="" type="checkbox"/>		23. Present Use Residence		37. Window Type(s) <input checked="" type="checkbox"/> 6 over 6 <input type="checkbox"/> 2 over 2 <input type="checkbox"/> 4 over 4 <input type="checkbox"/> Other															
13. Part of Estab. Hist. Dist.? Yes <input type="checkbox"/> No <input checked="" type="checkbox"/> 14. District Potential? Yes <input type="checkbox"/> No <input checked="" type="checkbox"/>		24. Ownership Public <input checked="" type="checkbox"/> Private <input type="checkbox"/>		38. Building Dimensions															
15. Name of Established District (N.R. or Local)		25. Owner's Name & Address, if known City of Middletown		39. Endangered? By What? Yes <input checked="" type="checkbox"/> Development No <input type="checkbox"/>															
		26. Property Acreage 83 (orig. 133)		40. Chimney Placement Central															
		27. Other Surveys in Which Included		41. Distance from and Frontage on Road 300 ft from highway 2800 ft frontage															
42. Further Description of Important Interior and Exterior Features (Continue on reverse if necessary)																			
Square structure with Italianate features (hipped roof, eaves brackets) with later Greek Revival porch added. Three bay, with front and back doors at side (north). Interior not observed. Rough limestone block foundation, basement.																			
43. History and Significance (Continue on reverse if necessary)		6. Specific Address or Location CINTI - DAYTON ROAD 1.5 MI SO. BLUEBALL																	
Probably built by Ellison Harkrader ca. 1850/60. Later occupied by his son. Not a particularly noteworthy example of the Italianate style, the building's significance is decreased by addition of later porches and attached garage.		46. Prepared by James L. Murphy																	
44. Description of Environment and Outbuildings (See #52)		47. Organization Ohio State University																	
Recent concrete block garage, small English style barn with concrete block addition, drive-in crib barn. Farm buildings surrounded by soybean fields except on west (recent park)		48. Date Recorded in Field 1991/August																	
45. Sources of Information		49. Revised by																	
Atlas of Butler County, Ohio. Philadelphia: Everts, 1875		50a. Date Revised																	
		50b. Reviewed by SCG SEP 10 1991																	

51. Condition of Property

- | | |
|---|---|
| <input checked="" type="checkbox"/> Excellent | <input type="checkbox"/> Ruin |
| <input type="checkbox"/> Good/Fair | <input type="checkbox"/> Destroyed/Burned |
| <input type="checkbox"/> Deteriorated | Date: _____ |

52. Historic Outbuildings and Dependencies

Barn Type(s)

English barn

Drive-in crib barn

- | | | |
|--|---------------------------------------|---------------------------------|
| Corn Crib or Shed <input type="checkbox"/> | Smoke House <input type="checkbox"/> | Privy <input type="checkbox"/> |
| Summer Kitchen <input type="checkbox"/> | Spring House <input type="checkbox"/> | Garage <input type="checkbox"/> |
| Silo <input type="checkbox"/> | Ice House <input type="checkbox"/> | |
| Designed landscape features <input type="checkbox"/> | | |

53. Affiliated OAI Site Number(s) _____ one _____ multiple

Archaeological Feature:	Observed	Expected on Basis of Archival Research
Well	_____	_____
Privy	_____	_____
Cistern	_____	_____
Foundation	_____	_____
Structural Rubble	_____	_____
Formal Trash Dump	_____	_____
Other _____	_____	_____

54. Farmstead Plan

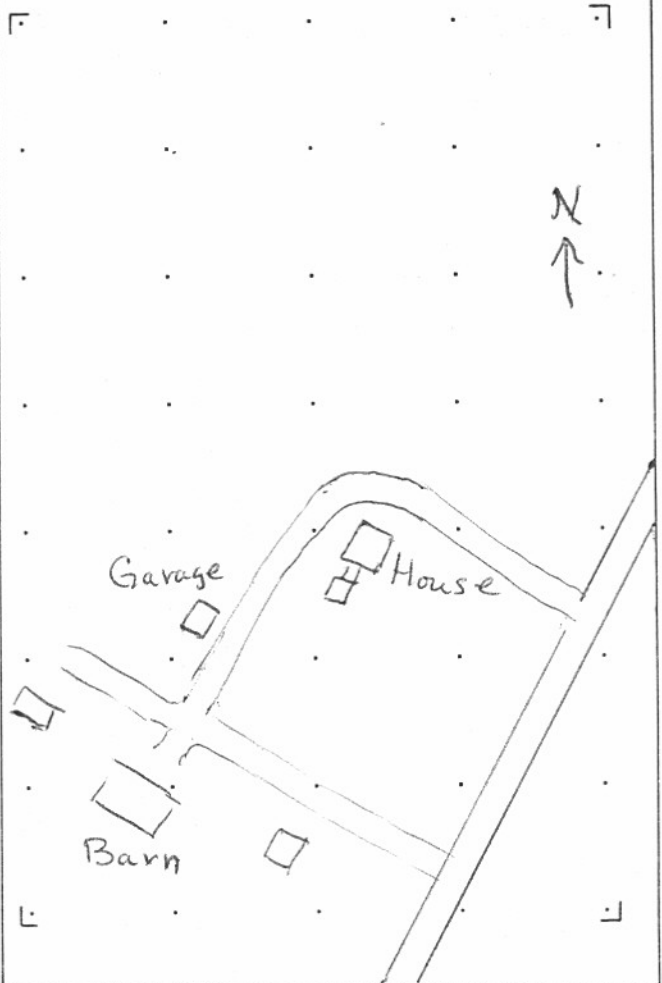

42. (Cont'd)

43. (Cont'd)