

OHIO HISTORIC INVENTORY

Ohio Historical Center
Columbus, Ohio 43211

1. No. **47 BUT. 91.8**

2. County **BUTLER**

3. Location of Negatives **CITY OF MIDDLETOWN**

4. Present Name(s) **517 S. MAIN STREET** **CODED**

5. Other Name(s)

6. Specific Location **517 S. MAIN STREET
(LOT 812, PARCEL 6, WARD 2)**

7. City or Town If Rural, Township & Vicinity **MIDDLETOWN, OHIO**

8. Thematic Category

9. Date(s) or Period **1890's - 1900's**

10. Style or Design **NON-DESCRIPT**

11. Architect or Engineer

12. Contractor or Builder

13. Original Use, if apparent **RESIDENTIAL**

14. Present Use **RESIDENTIAL**

15. Ownership Public Private

16. Owner's Name & Address, if known **STEPHEN COLLINS
517 S. MAIN STREET
MIDDLETOWN, OHIO**

17. No. of Stories **2**

18. Basement? Yes No

19. Foundation Material **STONE**

20. Wall Construction **FRAME**

21. Roof Type & Material **GABLE - ASPHALT SHINGLE**

22. No. of Bays Front **2** Side

23. Wall Treatment **WOOD SIDING**

24. Plan Shape **IRREGULAR**

25. Changes (Explain in #42) Addition Altered Moved

26. Condition Interior Exterior **FAIR**

27. Preservation Underway? Yes No

28. Endangered? By What? Yes No
ROOF NEEDS REPAIR

29. Visible from Public Road? Yes No

30. Distance from and Frontage on Road **1 PROP. FRONT 50'**

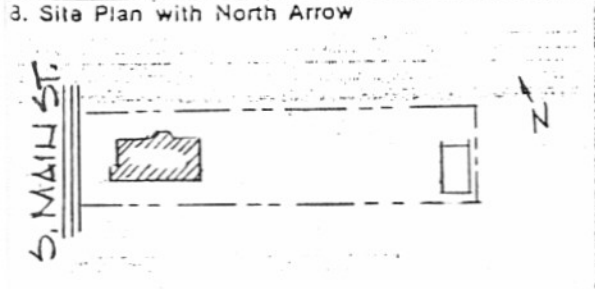

3. Coordinates Lat. **39° 31' N** Long. **84° 24' W**

U.T.M. Reference **14 722621 437637**

Zone Easting Northing

10. Site Building Structure Object

11. On National Register? Yes No

12. Is It Eligible? Yes No

13. Part of Estab. Hist. Dist.? Yes No

14. District Potant'l? Yes No

15. Name of Established District **S. Main Street Historic District**

16. Further Description of Important Features **HAS LARGE RED BRICK CHIMNEY, HOUSE ITSELF IS UNDECORATED.**

17. History and Significance

18. Description of Environment and Outbuildings **GARAGE AT REAR, LARGE TREES AT REAR**

19. Sources of Information **FIELD SURVEY**

20. Prepared by **LINDA WIENEKE**

21. Organization **CITY OF MIDDLETOWN**

22. Date **7/31/75** 23. Revision Date(s) **J.W. HOWARD**



REVISED 8/76

47 BUTLER 517 S. MAIN STREET

51. Condition of Property

- Excellent
- Good/Fair
- Deteriorated
- Ruin
- Destroyed/Burned
- Date _____

52. Historic Outbuildings and Dependencies

Barn Type(s)

- Corn Crib or Shed
- Summer Kitchen
- Silo
- Designed landscape features
- Smoke House
- Spring House
- Ice House
- Privy
- Garage

53. Affiliated OAI Site Number(s) _____ one _____ multiple

| | | | |
|-------------------------|----------|----------------------|--|
| Archaeological Feature: | Observed | Expected on Basis of | |
| | | Archival Research | |

- | | | | |
|-------------------|-------|-------|--|
| Well | _____ | _____ | |
| Privy | _____ | _____ | |
| Cistern | _____ | _____ | |
| Foundation | _____ | _____ | |
| Structural Rubble | _____ | _____ | |
| Formal Trash Dump | _____ | _____ | |
| Other _____ | _____ | _____ | |

54. Farmstead Plan

42. (Cont'd)

43. (Cont'd)