

OHIO HISTORIC INVENTORY CODED

Ohio Historical Center
Columbus, Ohio 43211

1. No. 30 BUT-74-8

2. County BUTLER

3. Location of Negatives CITY OF MIDDLETOWN

4. Present Name(s) 510 S. MAIN STREET

5. Other Name(s) CARNAHAN HOUSE

6. Specific Location
510 S. MAIN STREET
(LOT 887, PARCEL 13-14 WARD 2)

7. City or Town If Rural, Township & Vicinity
MIDDLETOWN, OHIO

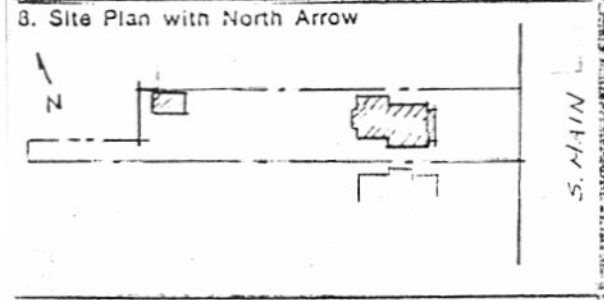

9. Coordinates
Lat 39° 31' N Long. 84° 24' W
U.T.M. Reference
18QJG12 4376918

10. Zone Easting Northing
Site Building Structure Object

11. On National Register? Yes No

12. Is it Eligible? Yes No

13. Part of Estab. Hist. Dist.? Yes No

14. District Potent'l? Yes No

15. Name of Established District
S. Main Street Historic District

16. Thematic Category C

17. Date(s) or Period 190's

18. Style or Design QUEEN ANNE

19. Architect or Engineer

20. Contractor or Builder

21. Original Use, if apparent RESIDENTIAL

22. Present Use RESIDENTIAL

23. Ownership Public Private

24. Owner's Name & Address, if known
VIOLA A. SLATTERY
510 S. MAIN STREET
MIDDLETOWN, OHIO

25. Open to Public? Yes No

26. Local Contact Person or Organization

27. Other Surveys in Which Included
NATIONAL REGISTER

28. No. of Stories 2 1/2

29. Basement? Yes No

30. Foundation Material STONE

31. Wall Construction BRICK

32. Roof Type & Material CABLE - ASPHALT SHINGLES

33. No. of Bays Front 3 Side

34. Wall Treatment PAINTED BRICK

35. Plan Shape IRREGULAR

36. Changes (Explain in #42) Addition Altered Moved

37. Condition Interior _____ Exterior VERY GOOD

38. Preservation Underway? NEW ROOF Yes No

39. Endangered? By What? Yes No

40. Visible from Public Road? Yes No

41. Distance from and Frontage on Road
PROP. FRONT 60±

12. Further Description of Important Features
BAY WINDOW ABOVE COVERED PORCH, BELOW CENTRAL GABLE; BRICK-WORK DETAIL AROUND DOOR, FLAT-SIDED ARCHED WINDOW OPENINGS.

13. History and Significance
ROBT, B. CARNAHAN WAS FIRST MAN (ENGINEER) TO BE HIRED BY ARMO, RESPONSIBLE FOR SPECIALITY STEEL, GIVING ARMO COMPETITIVE VALUE.

14. Description of Environment and Outbuildings
LARGE LOT - HOUSE SET BACK ON SITE, LARGE TREES IN FRONT YARD.

15. Sources of Information
FIELD SURVEY

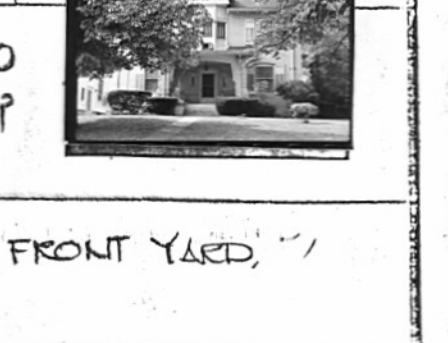

46. Prepared by STEVE D. CARR

47. Organization CITY OF MIDDLETOWN

48. Date 7/13/75 49. Revision Date(s) J.W. HOWARD

BUT-74-8
BUTLER
510 S. MAIN STREET

51. Condition of Property

- | | |
|---------------------------------------|---|
| <input type="checkbox"/> Excellent | <input type="checkbox"/> Ruin |
| <input type="checkbox"/> Good/Fair | <input type="checkbox"/> Destroyed/Burned |
| <input type="checkbox"/> Deteriorated | Date _____ |

52. Historic Outbuildings and Dependencies

Barn Type(s)

- | | | |
|--|---------------------------------------|---------------------------------|
| Corn Crib or Shed <input type="checkbox"/> | Smoke House <input type="checkbox"/> | Privy <input type="checkbox"/> |
| Summer Kitchen <input type="checkbox"/> | Spring House <input type="checkbox"/> | Garage <input type="checkbox"/> |
| Silo <input type="checkbox"/> | Ice House <input type="checkbox"/> | |
| Designed landscape features <input type="checkbox"/> | | |

53. Affiliated OAI Site Number(s) _____ one _____ multiple

Archaeological Feature:	Observed	Expected on Basis of Archival Research
Well	_____	_____
Privy	_____	_____
Cistern	_____	_____
Foundation	_____	_____
Structural Rubble	_____	_____
Formal Trash Dump	_____	_____
Other _____	_____	_____

54. Farmstead Plan

┌	.	.	.	└
.
.
.
.
.
.
└	.	.	.	┌

42. (Cont'd)

43. (Cont'd)