

# OHIO HISTORIC INVENTORY

CODED

Ohio Historic Preservation Office  
Ohio Historical Center  
Columbus, Ohio 43211

No. 28 BUT-728 4. Present Name(s) 502 S. MAIN STREET  
 County BUTLER 5. Other Name(s) R. C. PHILLIPS HOUSE  
 Location of Negatives CITY OF MIDDLETOWN

Specific Location 502 S. MAIN STREET WARD 2 (LOTS 879, 885, PARCEL 8, 9, 10)  
 City or Town If Rural, Township & Vicinity MIDDLETOWN OHIO

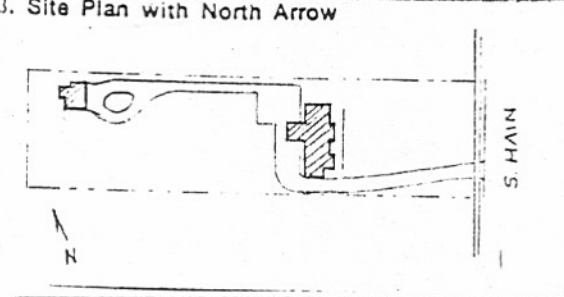

Coordinates at 39° 31' N Long. 84° 24' W  
 U.T.M. Reference

6	7	12	16	17	18	19	20
7	12	26	52	4	13	7	16
15	2			1	5	18	15
Easting				Northing			
Site <input type="checkbox"/>				Structure <input type="checkbox"/>			
Building <input checked="" type="checkbox"/>				Object <input type="checkbox"/>			

11. On National Register? Yes  No   
 12. Is It Eligible? Yes  No   
 13. Part of Estab. Dist. Yes  No   
 14. District Potent'l? Yes  No

Name of Established District S. Main Street Historic District

Further Description of Important Features  
LARGO BRICK HOUSE WITH STONE TRIM - SECOND STORY OF PLASTER AND TIMBER CONSTRUCTION. 2 LARGE BRICK CHIMNEYS, TUDOR ARCHED DOORWAY, WOODEN BAY WINDOW, CURRENTLY BEING USED AS A ROOMING HOUSE. COMPLETELY REMODELED IN 1917 BY R.C. PHILLIPS TO PRESENT APPEARANCE. 95' x 31' x 30' HIGH

16. Thematic Category C  
 17. Date(s) or Period 1890'S  
 18. Style or Design TIMBERFRAM  
 19. Architect or Engineer  
 20. Contractor or Builder  
 21. Original Use, if apparent RESIDENTIAL  
 22. Present Use RESIDENTIAL  
 23. Ownership Public  Private   
 24. Owner's Name & Address, If known BARRY BOWMAN, C. SMITH 1400 CENTRAL AVE

25. Open to Public? Yes  No   
 26. Local Contact Person or Organization

27. Other Surveys in Which Included  
NATIONAL REGISTER

28. No. of Stories 2 1/2  
 29. Basement? Yes  No   
 30. Foundation Material STONE  
 31. Wall Construction BRICK AND FRAME  
 32. Roof Type & Material GABLE, COMP ASPHALT SHING  
 33. No. of Bays Front 7 Side  
 34. Wall Treatment UNPAINTED WHITE PAINT ON BRICK WOOD TRIM  
 35. Plan Shape IRREGULAR  
 36. Changes Addition  Altered  Moved   
 37. Condition Interior \_\_\_\_\_ Exterior GOOD  
 38. Preservation Underway? Yes  No   
 39. Endangered? By What? Yes  No   
NEEDS MAINTENANCE  
 40. Visible from Public Road? Yes  No   
 41. Distance from and Frontage on Road PROP FRONT 150' ±



History and Significance

Description of Environment and Outbuildings  
LARGE GARAGE AND CIRCULAR DRIVE AT REAR, HUGE LOT LINED WITH TREES FRAMING THE HOUSE.

Sources of Information  
FIELD SURVEY  
TITLE SEARCH 8/76

46. Prepared by LINDA WIELLEKE  
 47. Organization CITY OF MIDDLETOWN  
 48. Date 1/1/75 49. Reporting District

BUT-728  
 BUTLER  
 502 S. MAIN STREET

51. Condition of Property

- |                                       |   |
|---------------------------------------|---|
| <input type="checkbox"/> Excellent    | <input type="checkbox"/> Ruin             |
| <input type="checkbox"/> Good/Fair    | <input type="checkbox"/> Destroyed/Burned |
| <input type="checkbox"/> Deteriorated | Date _____                                |

52. Historic Outbuildings and Dependencies

Barn Type(s)

---



---

- |  |                                       |                                 |
|--|---------------------------------------|---------------------------------|
| Corn Crib or Shed <input type="checkbox"/>           | Smoke House <input type="checkbox"/>  | Privy <input type="checkbox"/>  |
| Summer Kitchen <input type="checkbox"/>              | Spring House <input type="checkbox"/> | Garage <input type="checkbox"/> |
| Silo <input type="checkbox"/>                        | Ice House <input type="checkbox"/>    |                                 |
| Designed landscape features <input type="checkbox"/> |                                       |                                 |

53. Affiliated OAI Site Number(s) \_\_\_\_\_ one \_\_\_\_\_ multiple

Archaeological Feature:	Observed	Expected on Basis of Archival Research
Well	_____	_____
Privy	_____	_____
Cistern	_____	_____
Foundation	_____	_____
Structural Rubble	_____	_____
Formal Trash Dump	_____	_____
Other _____	_____	_____

54. Farmstead Plan

┌	.	.	.	└
.	.	.	.	.
.	.	.	.	.
.	.	.	.	.
.	.	.	.	.
.	.	.	.	.
.	.	.	.	.
└	.	.	.	┌

42. (Cont'd)

43. (Cont'd)