

CODED

Ohio Historic Preservation Office  
Ohio Historical Center  
Columbus, Ohio 43211

# OHIO HISTORIC INVENTORY

No. **17 BUT. 61.8**

County **BUTLER**

Location of Negatives **CITY OF MIDDLETOWN**

4. Present Name(s) **214-216 S. MAIN**

5. Other Name(s) **REINHARTZ HOME, THEODORE MARSTOLL HOUSE**

Specific Location **214 AND 216A S. MAIN ST. (LOT 8394, PARCEL 26, WARD 2)**

16. Thematic Category **C**

17. Date(s) or Period **1878**

18. Style or Design **RUSSAL VICTORIAN ITALIANATE**

28. No. of Stories **2 1/2**

29. Basement? Yes  No

30. Foundation Material **STONE**

31. Wall Construction **BRICK**

City or Town If Rural, Township & Vicinity **MIDDLETOWN, OHIO**

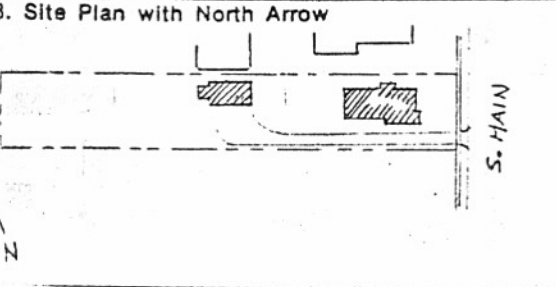

19. Architect or Engineer

20. Contractor or Builder **CHARLES E. MARGERUM**

21. Original Use, if apparent **RESIDENTIAL**

22. Present Use **RESIDENTIAL (DUPLEX)**

23. Ownership Public  Private

24. Owner's Name & Address, If known **NORBERT P. WACKER  
216 S. MAIN STREET  
MIDDLETOWN, OHIO**

32. Roof Type & Material **ITALIANATE**

33. No. of Bays Front **3** Side **5**

34. Wall Treatment **PEIGE PAINTED BRICK**

35. Plan Shape **RECTANGULAR**

36. Changes (Explain in #42) Addition  Altered  Moved

37. Condition Interior \_\_\_\_\_ Exterior **VERY GOOD**

38. Preservation Underway? Yes  No

39. Endangered? By What? Yes  No

40. Visible from Public Road? Yes  No

41. Distance from and Frontage on Road **PROP. FRONT 85±**

Coordinates

Lat. **39° 31' N** Long. **84° 24' W**

U.T.M. Reference **6 712281318 413767918**

Eastings	Northing
Site <input type="checkbox"/> Building <input checked="" type="checkbox"/>	Structure <input type="checkbox"/> Object <input type="checkbox"/>
On National Register? Yes <input type="checkbox"/> No <input checked="" type="checkbox"/>	12. Is It Eligible? Yes <input type="checkbox"/> No <input type="checkbox"/>
Part of Estab. Hist. Dist.? Yes <input type="checkbox"/> No <input type="checkbox"/>	14. District Potent'ly? Yes <input checked="" type="checkbox"/> No <input type="checkbox"/>

Name of Established District **S. Main Street Historic District**

25. Open to Public? Yes  No

26. Local Contact Person or Organization

27. Other Surveys In Which Included **NATIONAL REGISTER**

Further Description of Important Features

**TWO PAINTED BRICK CHIMNEYS, BROKEN ROUND ARCHED PEDIMENT, ARCHITRAVE, DORIC COLUMNS AT ENTRANCE, CAST IRON DETAILS - EAVE BRACKETS AND HOODMOLDS, IRON BALCONIES AROUND SECOND FLOOR WINDOWS, SMALL VERANDA ON S.E. CORNER. 1913 ADDITION AT REAR, CONVERTED TO APARTMENTS**

**35' x 70' x 30' HIGH**



History and Significance

**REINHARTZ - ENGINEER AT ARMCO, HELPED G.M. VERITY BUILT EAST WORKS AT ARMCO - REINHARTZ BLD. (MAJOR BLD IN MIDDLETOWN AFTER HIM.)**

Description of Environment and Outbuildings

**WELL SHADED AND LANDSCAPED LOT, EXTERIOR LIGHTS COMPATIBLE TRAFFIC NORTH AND SOUTH ON S. MAIN STREET, PARKING IN FRONT FOR FUERXU HOME, WELL MAINTAINED LAWN, MIXTURE OF TREES, BRICK & WOOD CONVERTED STABLE GARAGE AND FAMILY ROOM.**

Sources of Information **FIELD SURVEY  
INTERVIEW WITH MR. NORBERT WACKER**

48. Prepared by **LINDA WIENEKE**

47. Organization **CITY OF MIDDLETOWN**

No. **BUT. 61.8**  
 County **BUTLER**  
 Location of Negatives **CITY OF MIDDLETOWN**  
 No. of Photos **214-216 S. MAIN STREET**  
 Name of Property **REINHARTZ HOME, MARSTOLL HOUSE**

51. Condition of Property

- |                                       |   |
|---------------------------------------|---|
| <input type="checkbox"/> Excellent    | <input type="checkbox"/> Ruin             |
| <input type="checkbox"/> Good/Fair    | <input type="checkbox"/> Destroyed/Burned |
| <input type="checkbox"/> Deteriorated | Date _____                                |

52. Historic Outbuildings and Dependencies

Barn Type(s)

---



---

- |  |                                       |                                 |
|--|---------------------------------------|---------------------------------|
| Corn Crib or Shed <input type="checkbox"/>           | Smoke House <input type="checkbox"/>  | Privy <input type="checkbox"/>  |
| Summer Kitchen <input type="checkbox"/>              | Spring House <input type="checkbox"/> | Garage <input type="checkbox"/> |
| Silo <input type="checkbox"/>                        | Ice House <input type="checkbox"/>    |                                 |
| Designed landscape features <input type="checkbox"/> |                                       |                                 |

53. Affiliated OAI Site Number(s) \_\_\_\_\_ one \_\_\_\_\_ multiple

Archaeological Feature:	Observed	Expected on Basis of Archival Research
Well	_____	_____
Privy	_____	_____
Cistern	_____	_____
Foundation	_____	_____
Structural Rubble	_____	_____
Formal Trash Dump	_____	_____
Other _____	_____	_____

54. Farmstead Plan

┌	.	.	.	┐
.	.	.	.	.
.	.	.	.	.
.	.	.	.	.
.	.	.	.	.
.	.	.	.	.
.	.	.	.	.
└	.	.	.	┘

42. (Cont'd)

43. (Cont'd)